

## Preliminary Data Sheet

The APC-Q062

series power module is a low profile DC/DC converter, which operates over an input voltage range of 36V to 75V and provides precisely regulated dual DC outputs.

The outputs are fully isolated from the input and has a maximum power rating of 60 watts.

The power module is suited for board level applications in a distributed power architecture requiring isolated power.

Industry standard size:

36.8mm x 57.9mm x 10.2mm

Industry standard terminal pin configuration

## FEATURES

- ❑ High Efficiency: 90% at full load
- ❑ Operates at the rated wattage without requiring a heat-sink
- ❑ Wide input voltage range: 36V-75V with 100V, 100ms input voltage transient protection
- ❑ Fixed Frequency
- ❑ Adjustable output voltage
- ❑ Low output noise
- ❑ Overtemperature protection
- ❑ Output overvoltage protection
- ❑ Output overcurrent protection
- ❑ Remote sense & Remote on/off
- ❑ Case ground pin
- ❑ Constant frequency
- ❑ 1500Vdc isolation (input to output)
- ❑ Designed to meet UL60950, EN60950 and CE mark requirements

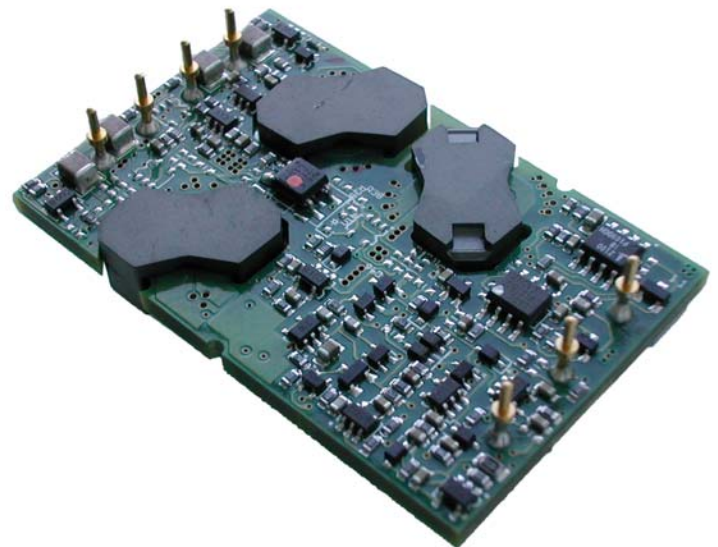

## APC-Q062 Quarter Brick Dual Output DC-DC Converter - 48Vi, 5.0 & 3.3Vo 60W

### Preliminary Data Specification

Characteristics	Conditions	Min	Typ	Max	Unit
Efficiency	$V_i = V_{i,nom}$ , $I_o = I_o, max$ , $T_c = 25^\circ C$ , $I_o = 50\%$ of each output	-	90	-	%
Switching frequency		-	170	-	kHz
Isolation resistance input to output		-	10	-	
Calculated MTBF		1.5	-	-	Mhr
Weight		-	40	-	g

Characteristics	Min	Max	Unit
$T_m$ Module Operating Temperature	-40	115	$^\circ C$
$T_{slg}$ Storage temperature	-55	125	$^\circ C$
$V_i$ Input voltage (continuous)	-	75	Vdc
$V_{i,trans}$ Transient input voltage (100ms)	-	100	V
Viso Input to output isolation voltage	-	1500	V

Characteristics	Conditions	Output			Unit
		Min	Typ	Max	
$V_o$ Output voltage set point (5.0V)	$V_i = V_{i,nom}$ , $I_o = I_o, max$ , $T_c = 25^\circ C$	-	4.98	-	V
			3.29		
$I_o$ Output current (5.0V)		0	-	12	A
		0	-	18	
$P_{o,max}$ Maximum output power		-	-	60	W

Input Characteristics	Min	Typ	Max	Unit
V Operating input voltage	36	48	75	V
$i_{i,max}$ Maximum input current	-	-	2.5	A
$I_t$ Inrush transient	-	-	0.1	A's
$I_{rr}$ Input reflected-ripple current, peak-to-peak (5Hz to 20MHz)		20		mA (p-p)
$I_r$ Input ripple rejection (120Hz)	-	-60	-	dB

### Mechanical Outline

Dimensions are in millimetres and (inches)

Tolerances: x.x mm  $\pm$  0.5mm [x.xx in.  $\pm$  0.02 in.]  
 x.xx mm  $\pm$  0.25mm [x.xxx in.  $\pm$  0.010 in.]

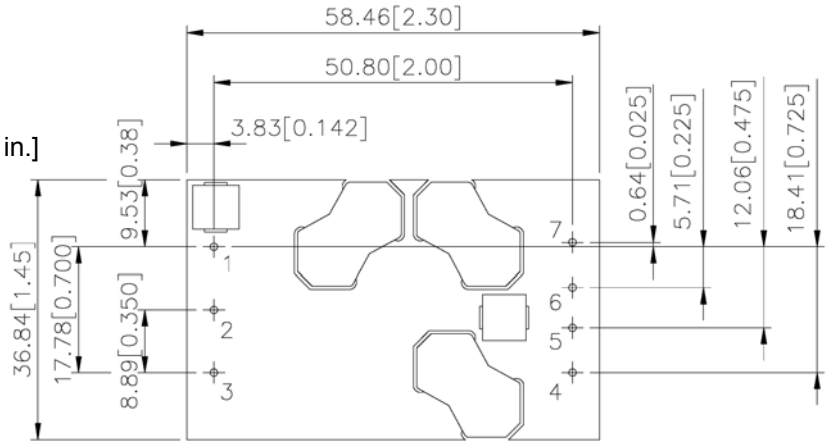

TOP VIEW

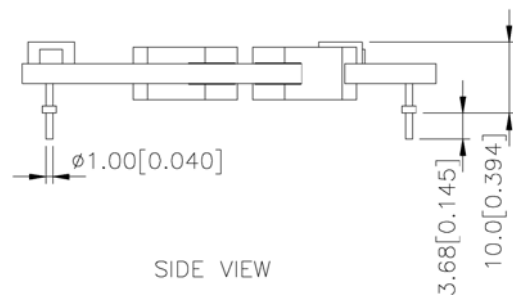

SIDE VIEW



BOTTOM VIEW

### Pin Symbol Definition

- 1 VI (+) Position input voltage
- 2 ON/OFF Remote on/off control
- 3 VI (-) Negative input voltage
- 4 3.3Vo(+) 3.3V position output voltage
- 5 RTN(-) Negative output voltage
- 6 TRIM Output voltage adjustment
- 7 5.0Vo(+) 5.0V position output voltage

Exceeding absolute maximum ratings may cause permanent damage and may reduce reliability. Information and specifications contained in this data sheet are believed to be correct at the time of publication. However, APC accept no responsibility for consequences arising from printing errors or inaccuracies. Specifications are subject to change without notice.